

d1 = 3-9 mm

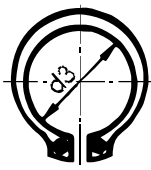

d1 > 10 mm

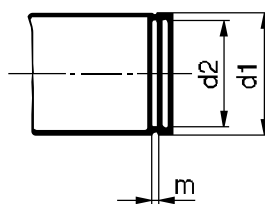
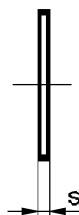

| Арт. номер | d 1 | d 3 | толеранс | d 2 | s | m |
|-------------|-----|------|----------|------|------|------|
| | 3 | 2.7 | - | 2.8 | 0.40 | 0.50 |
| 191 005 001 | 4 | 3.7 | + 0.04 | 3.8 | 0.40 | 0.50 |
| 191 005 002 | 5 | 4.7 | - 0.15 | 4.8 | 0.60 | 0.70 |
| 191 005 003 | 6 | 5.6 | - | 5.7 | 0.70 | 0.80 |
| 191 005 004 | 7 | 6.5 | + 0.06 | 6.7 | 0.80 | 0.90 |
| 191 005 005 | 8 | 7.4 | -0.18 | 7.6 | 0.80 | 0.90 |
| 191 005 006 | 9 | 8.4 | - | 8.6 | 1.00 | 1.10 |
| 191 005 007 | 10 | 9.3 | - | 9.6 | 1.00 | 1.10 |
| 191 005 008 | 11 | 10.2 | - | 10.5 | 1.00 | 1.10 |
| 191 005 009 | 12 | 11.0 | - | 11.5 | 1.00 | 1.10 |
| 191 005 010 | 13 | 11.9 | - | 12.4 | 1.00 | 1.10 |
| 191 005 011 | 14 | 12.9 | + 0.10 | 13.4 | 1.00 | 1.10 |
| 191 005 012 | 15 | 13.8 | - 0.36 | 14.3 | 1.00 | 1.10 |
| 191 005 013 | 16 | 14.7 | - | 15.2 | 1.00 | 1.10 |
| 191 005 014 | 17 | 15.7 | - | 16.2 | 1.00 | 1.10 |
| 191 005 015 | 18 | 16.5 | - | 17.0 | 1.20 | 1.30 |
| 191 005 016 | 19 | 17.5 | - | 18.0 | 1.20 | 1.30 |
| 191 005 017 | 20 | 18.5 | - | 19.0 | 1.20 | 1.30 |
| 191 005 018 | 21 | 19.5 | + 0.13 | 20.0 | 1.20 | 1.30 |
| 191 005 019 | 22 | 20.5 | - 0.42 | 21.0 | 1.20 | 1.30 |
| 191 005 020 | 23 | 21.5 | - | 22.0 | 1.20 | 1.30 |
| 191 005 021 | 24 | 22.2 | - | 22.9 | 1.20 | 1.30 |
| 191 005 022 | 25 | 23.2 | - | 23.9 | 1.20 | 1.30 |
| 191 005 023 | 26 | 24.2 | - | 24.9 | 1.20 | 1.30 |
| 191 005 024 | 27 | 24.9 | + 0.21 | 25.6 | 1.20 | 1.30 |
| 191 005 025 | 28 | 25.9 | - 0.42 | 26.6 | 1.50 | 1.60 |
| 191 005 026 | 29 | 26.9 | - | 27.6 | 1.50 | 1.60 |
| 191 005 027 | 30 | 27.9 | - | 28.6 | 1.50 | 1.60 |
| 191 005 028 | 31 | 28.6 | - | 29.3 | 1.50 | 1.60 |
| 191 005 029 | 32 | 29.6 | - | 30.3 | 1.50 | 1.60 |
| 191 005 030 | 33 | 30.5 | - | 31.3 | 1.50 | 1.60 |
| 191 005 031 | 34 | 31.5 | - | 32.3 | 1.50 | 1.60 |
| 191 005 032 | 35 | 32.2 | + 0.25 | 33.0 | 1.50 | 1.60 |
| 191 005 033 | 36 | 33.2 | - 0.50 | 34.0 | 1.75 | 1.85 |
| 191 005 034 | 37 | 34.2 | - | 35.0 | 1.75 | 1.85 |
| 191 005 035 | 38 | 35.2 | - | 36.0 | 1.75 | 1.85 |
| 191 005 036 | 39 | 36.0 | - | 37.0 | 1.75 | 1.85 |
| 191 005 037 | 40 | 36.5 | - | 37.5 | 1.75 | 1.85 |
| 191 005 038 | 41 | | | | | |

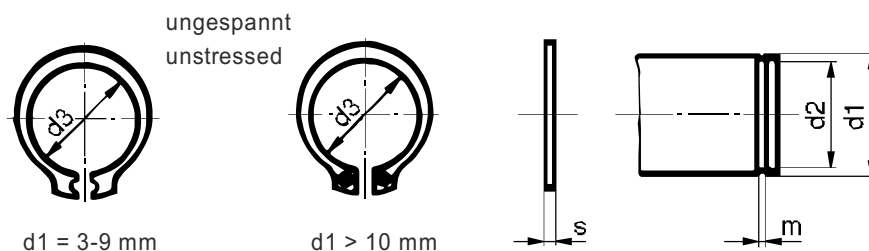

| Арт. номер | d 1 | d 3 | толеранс | d 2 | s | m |
|-------------|-----|------|----------|------|------|------|
| 191 005 039 | 42 | 38.5 | - | 39.5 | 1.75 | 1.85 |
| 191 005 040 | 44 | 40.5 | - | 41.5 | 1.75 | 1.85 |
| 191 005 041 | 45 | 41.5 | + 0.39 | 42.5 | 1.75 | 1.85 |
| 191 005 042 | 46 | 42.5 | - 0.90 | 43.5 | 1.75 | 1.85 |
| 191 005 043 | 47 | 43.5 | - | 44.5 | 1.75 | 1.85 |
| 191 005 044 | 48 | 44.5 | - | 45.5 | 1.75 | 1.85 |
| 191 005 105 | 49 | | | | | |
| 191 005 045 | 50 | 45.8 | - | 47.0 | 2.00 | 2.15 |
| 191 005 046 | 52 | 47.8 | - | 49.0 | 2.00 | 2.15 |
| 191 005 047 | 54 | 49.8 | - | 51.0 | 2.00 | 2.15 |
| 191 005 048 | 55 | 50.8 | - | 52.0 | 2.00 | 2.15 |
| 191 005 049 | 56 | 51.8 | - | 53.0 | 2.00 | 2.15 |
| 191 005 050 | 57 | 52.8 | - | 54.0 | 2.00 | 2.15 |
| 191 005 051 | 58 | 53.8 | - | 55.0 | 2.00 | 2.15 |
| 191 005 052 | 60 | 55.8 | - | 57.0 | 2.00 | 2.15 |
| 191 005 053 | 62 | 57.8 | - | 59.0 | 2.00 | 2.15 |
| 191 005 054 | 63 | 58.8 | + 0.46 | 60.0 | 2.00 | 2.15 |
| 191 005 055 | 65 | 60.8 | - 1.10 | 62.0 | 2.5 | 2.65 |
| 191 005 056 | 67 | | | | | |
| 191 005 057 | 68 | 63.5 | - | 65.0 | 2.5 | 2.65 |
| 191 005 058 | 70 | 65.5 | - | 67.0 | 2.5 | 2.65 |
| 191 005 059 | 72 | 67.5 | - | 69.0 | 2.5 | 2.65 |
| 191 005 060 | 75 | 70.5 | - | 72.0 | 2.5 | 2.65 |
| 191 005 061 | 77 | | | | | |
| 191 005 062 | 78 | 73.5 | - | 75.0 | 2.5 | 2.65 |
| 191 005 063 | 80 | 74.5 | - | 76.5 | 2.5 | 2.65 |
| 191 005 064 | 82 | 76.5 | - | 78.5 | 2.5 | 2.65 |
| 191 005 065 | 85 | 79.5 | - | 81.5 | 3.0 | 3.15 |
| 191 005 066 | 87 | | | | | |
| 191 005 067 | 88 | 82.5 | - | 84.5 | 3.0 | 3.15 |
| 191 005 068 | 90 | 84.5 | - | 86.5 | 3.0 | 3.15 |
| 191 005 069 | 92 | | | | | |
| 191 005 070 | 95 | 89.5 | - | 91.5 | 3.0 | 3.15 |
| 191 005 071 | | | | | | |
| 191 005 072 | | | | | | |
| 191 005 073 | 100 | 94.5 | | 96.5 | 3.0 | 3.15 |
| 191 005 074 | 102 | | | | | |

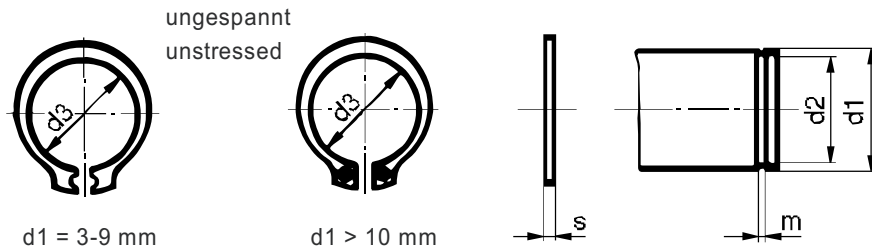

| Арт. номер | d 1 | d 3 | толеранс | d 2 | s | m |
|-------------|-----|-------|----------|-------|-----|------|
| 191 005 075 | 105 | 98.0 | + 0.54 | 101.0 | 4.0 | 4.15 |
| 191 005 076 | 107 | | | | | |
| 191 005 077 | 108 | | | | | |
| 191 005 078 | 110 | 103.0 | - 1.30 | 106.0 | 4.0 | 4.15 |
| 191 005 079 | 112 | | | | | |
| 191 005 080 | 115 | 108.0 | - | 111.0 | 4.0 | 4.15 |
| 191 005 081 | 117 | | | | | |
| 191 005 082 | 118 | | | | | |
| 191 005 083 | 120 | 113.0 | - | 116.0 | 4.0 | 4.15 |
| 191 005 084 | 122 | | | | | |
| 191 005 085 | 125 | 118.0 | - | 121.0 | 4.0 | 4.15 |
| 191 005 086 | 127 | | | | | |
| 191 005 087 | 128 | | | | | |
| 191 005 088 | 130 | 123.0 | - | 126.0 | 4.0 | 4.15 |
| 191 005 089 | 132 | | | | | |
| 191 005 090 | 135 | 128.0 | - | 131.0 | 4.0 | 4.15 |
| 191 005 091 | 137 | | | | | |
| 191 005 092 | 138 | | | | | |
| 191 005 093 | 140 | 133.0 | - | 136.0 | 4.0 | 4.15 |
| 191 005 094 | 142 | | | | | |
| 191 005 095 | 145 | 138.0 | - | 141.0 | 4.0 | 4.15 |
| 191 005 096 | 147 | | | | | |
| 191 005 097 | 148 | | | | | |
| 191 005 098 | 150 | 142.0 | - | 145.0 | 4.0 | 4.15 |
| 191 005 099 | 155 | 146.0 | - | 150.0 | 4.0 | 4.15 |
| 191 005 100 | 160 | 151.0 | - | 155.0 | 4.0 | 4.15 |
| 191 005 101 | 165 | 155.0 | - | 160.0 | 4.0 | 4.15 |
| 191 005 102 | 170 | 160.5 | - | 165.0 | 4.0 | 4.15 |
| 191 005 103 | 175 | 165.5 | - | 170.0 | 4.0 | 4.15 |
| 191 005 104 | 180 | 170.5 | - | 175.0 | 4.0 | 4.15 |
| | 185 | 175.5 | - | 180.0 | 4.0 | 4.15 |
| | 190 | 180.5 | - | 185.0 | 4.0 | 4.15 |
| | 195 | 185.5 | - | 190.0 | 4.0 | 4.15 |
| | 200 | 190.5 | + 0.72 | 195.0 | 4.0 | 4.15 |
| | 210 | 198.0 | - 1.70 | 204.0 | 5.0 | 5.15 |
| | 220 | 208.0 | | 214.0 | 5.0 | 5.15 |
| | 230 | 218.0 | | 224.0 | 5.0 | 5.15 |
| | 240 | 228.0 | | 234.0 | 5.0 | 5.15 |